

# ASSEMBLY INSTRUCTIONS

---

700/750/800/1200/1500/1800 x 525mm  
Eclipse Desk Mounted Partiton / Screen

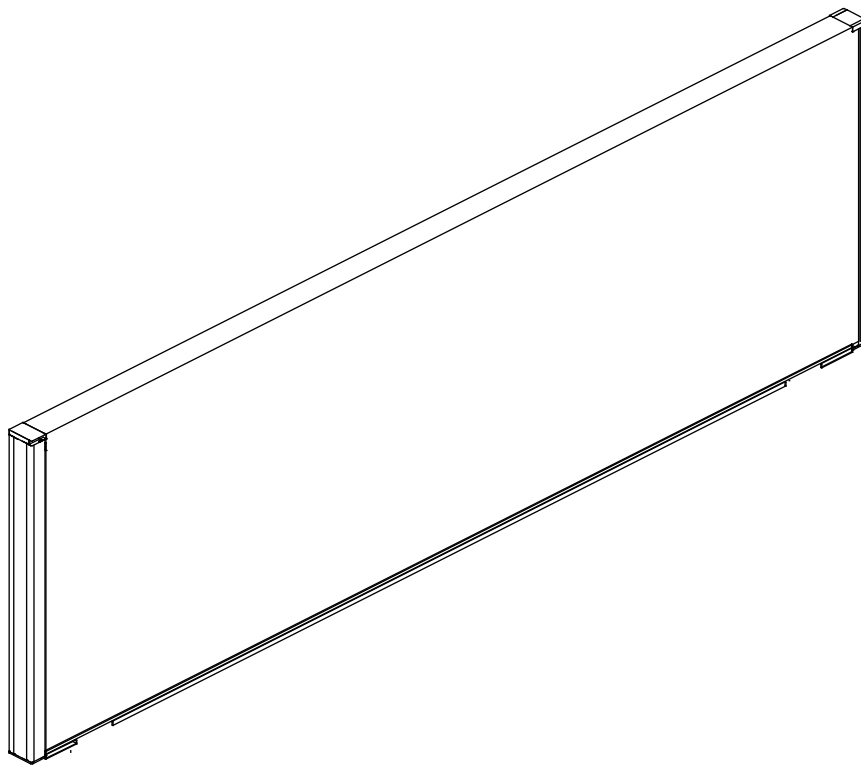

[www.accessoffice.com.au](http://www.accessoffice.com.au)

 **Eclipse**®  
*Built Tough to Last*

Estimated Assembly Time: 10 minutes

People Required

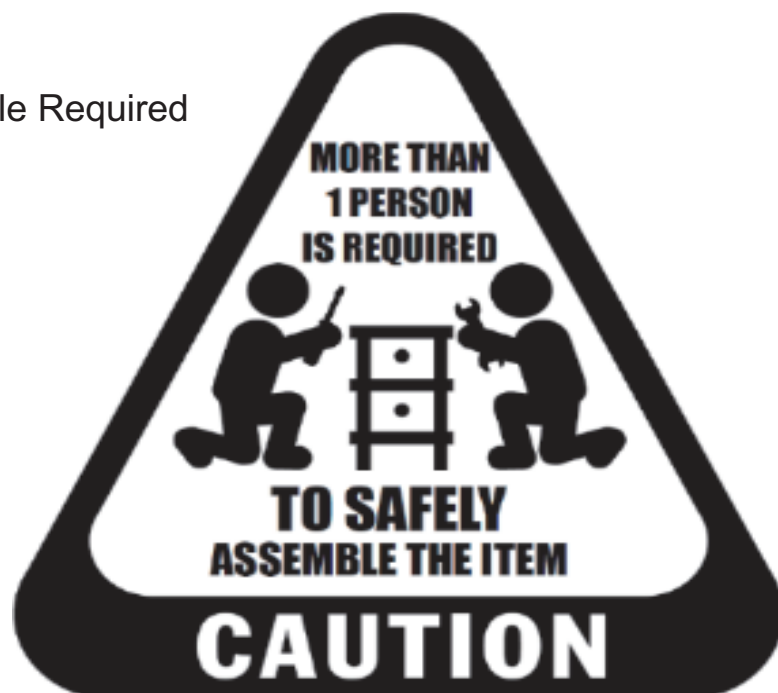

General Advice



### Tools Required

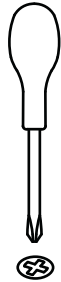

**CAUTION:** Do not use tools other than those required, as this can damage your new item.

### NOTE

- Please check you have all hardware before assembling.
- If you are missing any hardware, please contact Access for replacements
- Please ensure you have the name of the item, required hardware part and quantity.
- Please retain your invoice as proof of purchase to validate your warranty.

### CAUTION

- Do not tighten screws before all screws are in the right place.
- Do not use this product unless all screws are firmly secured.
- Check that all screws are securely tightened at least every 4 months.

### WARNING

- If parts are missing, broken, damaged or worn, stop using the product until all repairs are made using manufacturer authorised parts.
- Failure to follow these warnings could result in serious injury.

### DANGER

- CHILDREN MUST BE SUPERVISED.

## Parts List

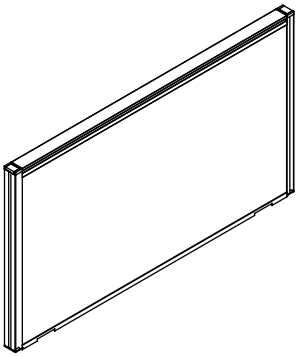
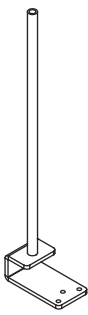
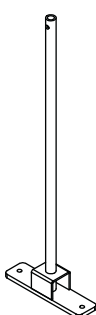
<p>1</p>  <p>1pc</p>	<p>2</p>  <p>2pcs</p>	<p>3</p>  <p>2pcs</p>
---	---	--

## Hardware List

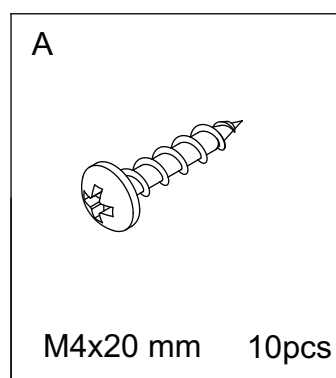

Compatible with single or back to back desks

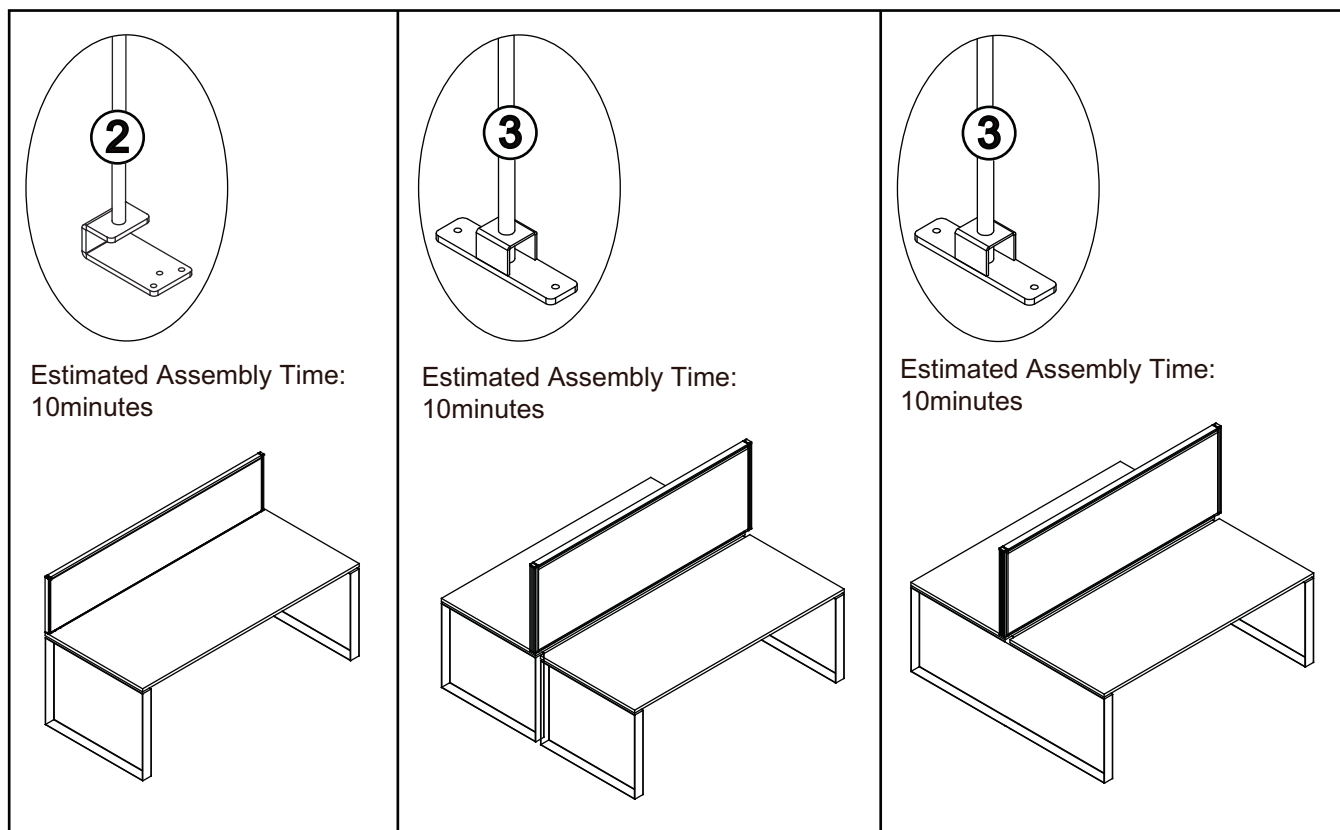

## Step 1

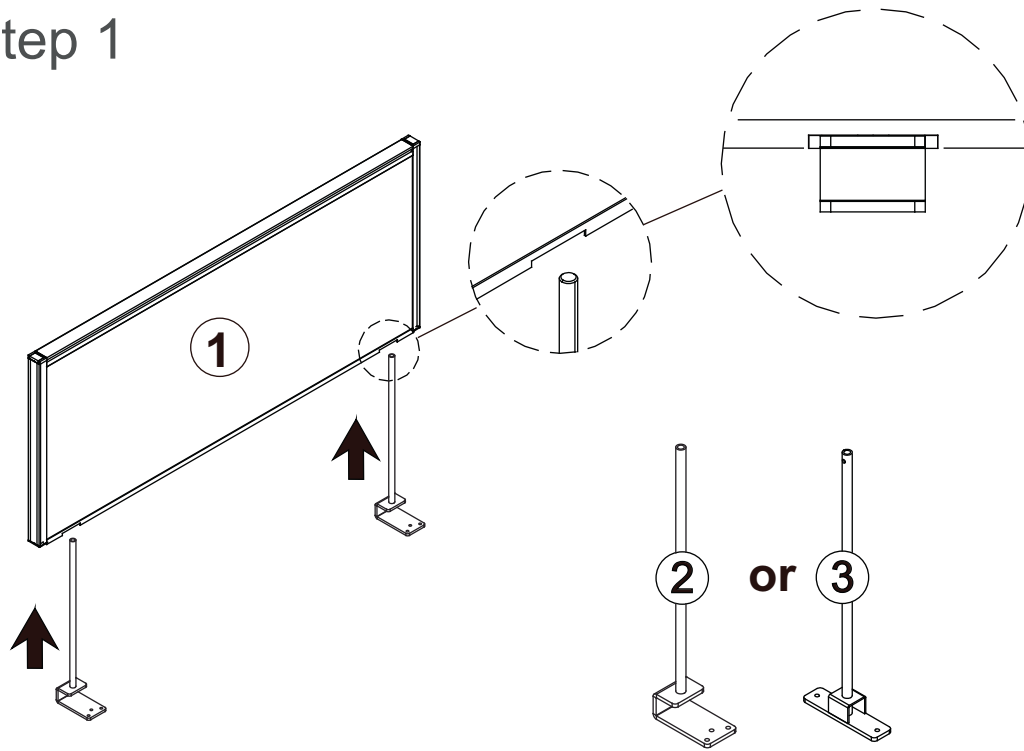

## Desk top

### Single desk

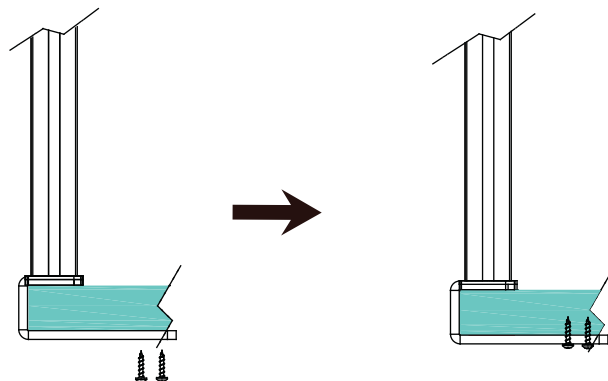
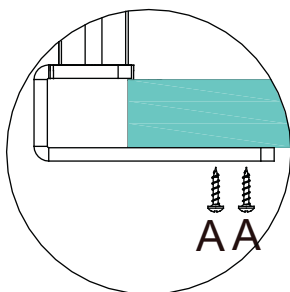

### Back to back desk

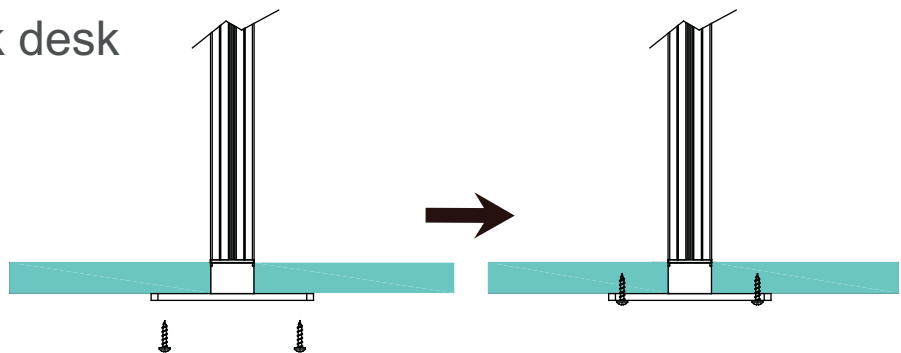
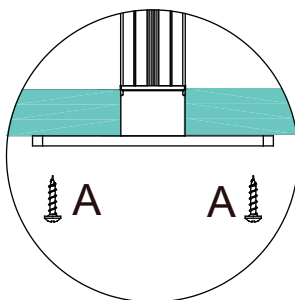

## Step 2 Single desk

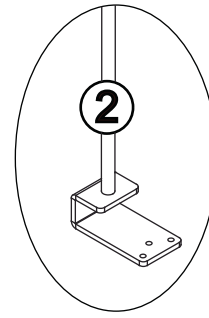
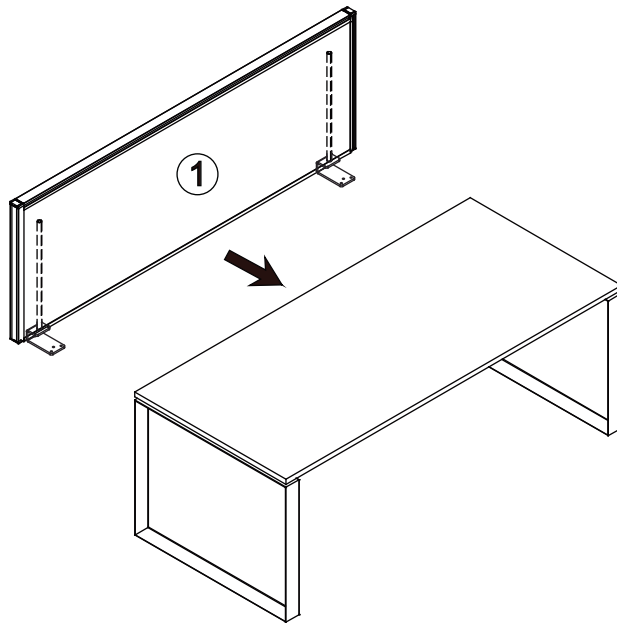

## Back to back desks

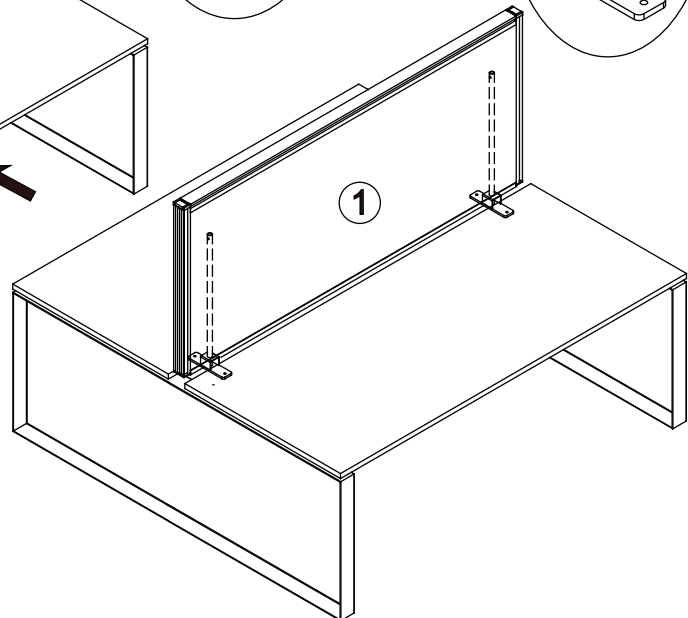
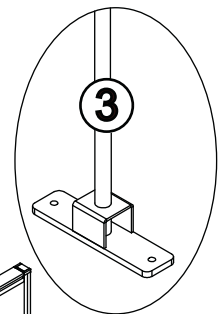
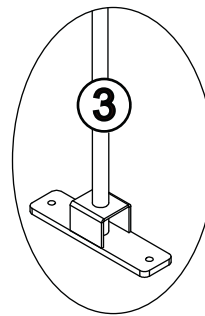
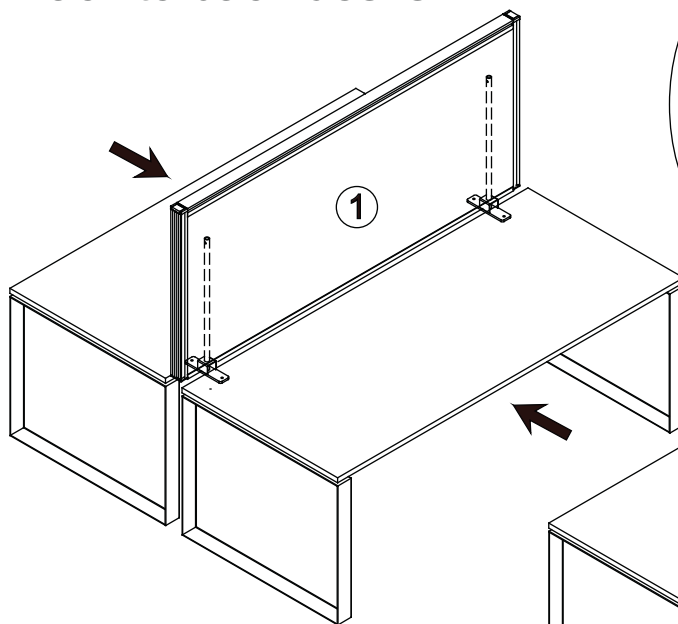

## **Warranty 15 years**

### **Product Warranty – valid for Australian customers only**

Access Office Industries warrants that this product will be free from defects and work as intended for 15 years from the date of purchase by the original customer.

If the product has any defects or does not work as intended during the Warranty Period, Access will, at its election and at its expense, repair or replace the product.

This warranty does not apply:

- To cosmetic damage;
  - To damage caused by consumables used in connection with the product (such as cleaning products);
  - Where the product has not been used in accordance with all provided instructions;
  - To damage arising from fair wear and tear;
  - Where the product has not been subject to reasonable use;
  - Where the product has been intentionally or negligently damaged; and/or
- if the customer has attempted to repair the product.

To make a claim under this warranty, please return your product with your Invoice or proof of purchase to Access Office Industries Perth Warehouse

This warranty is provided in addition to any rights you may be entitled to under the Competitions & Consumer Act 2010.

Our goods come with guarantees that cannot be excluded under the Australian Consumer Law. You are entitled to a replacement or refund for a major failure and compensation for any other reasonably foreseeable loss or damage. You are also entitled to have the goods repaired or replaced if the goods fail to be of acceptable quality and the failure does not amount to a major failure.

Thankyou for your purchase. Please retain yor invoice to validate your warranty.  
If you would like to know more about Access Office Industries Furniture Products,  
Please visit [www.accessoffice.com.au](http://www.accessoffice.com.au)

