

# assembly instructions

# TAMBOUR CUPBOARDS

*Making Life Easier*

- A Back panels, 1 off left and 1 right per cupboard
- B Side panels, 1 off left and right per cupboard
- C Base frame, 1 off
- D Kick plate, 1 off
- E Top panel, 1 off
- F Tambour doors, 1 off left and right per cupboard
- G Inner side board, 1 off left and right per cupboard
- H Base, 1 per cupboard

- I Shelf
- J Shelf clips, 4 off per shelf
- K M6×12 Phillips head screws, 10 pieces per cupboard
- L M4×12 pan head needle point screws, 6 pieces per cupboard
- M M4×12 pan head needle point screws, 2 pieces per cupboard
- N Door centre stops, 1 top and 1 bottom per cupboard
- O Adjustable feet, 4 off per cupboard

## Tambour Door Cabinets

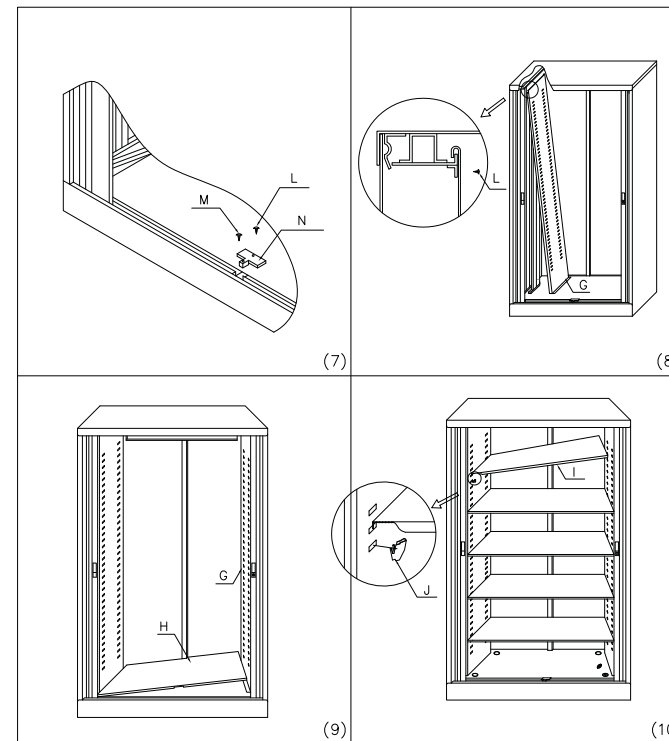
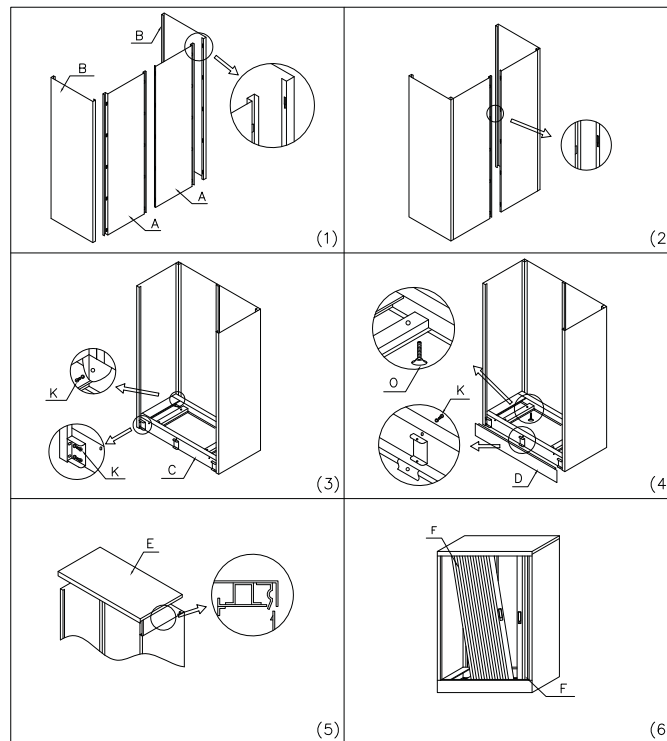
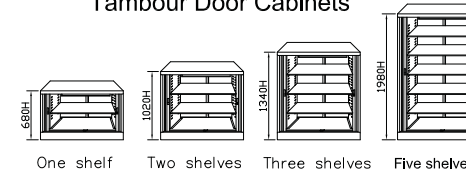

Copyright 2008. Profile Storage Group Australia. Last updated by Jamie Noble-Emory on 10/09/2008

**AUS FILE®**

is a wholly owned trademark of the Global group of companies